

ORFS FEMALE SWIVEL 90° ELBOW

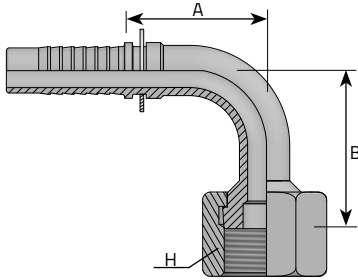

FEMMINA 90° ORFS
 FEMELLE 90° ORFS
 DK 90° BOGEN ORFS UNF STIRNDICHTEND
 HEMBRA GIRATORIA A 90° ORFS

Code	Tube		Thread		Dimensions				Pressure	
	D.N.	Hose	Diam	T	t/1"	H	B	A	Bar	Psi
	Inch	Inch	mm	Inch		mm	mm	mm		
F900RFS0406	-4	1/4"	6.4	9/16"	18	17	29.5	28	450	6526
F900RFS0409	-4	1/4"	6.4	11/16"	16	22	30	28	450	6526
F900RFS0411	-4	1/4"	6.4	13/16"	16	-	24	-	-	-
F900RFS0509	-5	5/16"	7.9	11/16"	16	22	29	29	350	5076
F900RFS0606	-6	3/8"	9.5	9/16"	18	17	25	29.5	-	-
F900RFS0609	-6	3/8"	9.5	11/16"	16	22	29	36	445	6454
F900RFS0611	-6	3/8"	9.5	13/16"	16	24	32	34	445	6454
F900RFS0809	-8	1/2"	12.8	11/16"	16	22	34	39.5	-	-
F900RFS0811	-8	1/2"	12.8	13/16"	16	24	36	37.5	415	6019
F900RFS0813	-8	1/2"	12.8	1"	14	30	39	39	415	6019
F900RFS0814	-8	1/2"	12.8	1.3/16"	12	36	41	38	415	6019
F900RFS1013	-10	5/8"	16	1"	14	30	43.5	51.5	350	5076
F900RFS1014	-10	5/8"	16	1.3/16"	12	36	48	46.5	350	5076
F900RFS1214	-12	3/4"	19	1.3/16"	12	36	49	56	350	5076
F900RFS1215	-12	3/4"	19	1.7/16"	12	41	54	56.5	350	5076
F900RFS1615	-16	1"	25.4	1.7/16"	12	41	59.5	74	280	4061
F900RFS2021	-20	1.1/4"	31.8	1.11/16"	12	50	75.5	90	210	3046
F900RFS2432	-24	1.1/2"	38.1	2"	12	60	84	99	185	2683