

FLANGE CODE 62 - 6000 PSI - 45° ELBOW

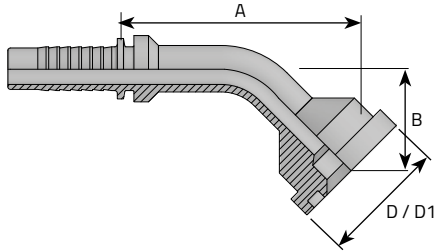

FLANGIA A 45° SAE J518 6000 PSI INTERA
 BRIDE 45° 6000 PSI (PIÈCE ENTIER)
 45° FLANSCHANSCHLUSS 6000 PSI – EINTEILIG
 BRIDA A 45° 6000 PSI (PIEZA UNICA)

Do Not Include O-Ring / O-Ring Non Compresso /
 Sans O-Ring / Ohne O-Ring/ Sin O-Ring

Code	Tube			Thread	Dimensions				Pressure	
	D.N.	Hose	Diam		D	D1	B	A	Bar	Psi
		Inch	mm		Inch	mm	mm	mm		
F45P0808I	-8	1/2"	12.8		1/2"	31.7	23	64	415	6019
F45P0812I	-8	1/2"	12.8		3/4"	41.3	28	69	415	6019
F45P1008I	-10	5/8"	16		1/2"	31.7	26	60	350	5076
F45P1012I	-10	5/8"	16		3/4"	41.3	30	66	350	5076
F45P1208I	-12	3/4"	19		1/2"	31.7	28	64	350	5076
F45P1212I	-12	3/4"	19		3/4"	41.3	32	70	350	5076
F45P1216I	-12	3/4"	19		1"	47.6	35	74	350	5076
F45P1612I	-16	1"	25.4		3/4"	41.3	35	86	280	4061
F45P1616I	-16	1"	25.4		1"	47.6	32	89	280	4061
F45P1620I	-16	1"	25.4		1.1/4"	54	36	94	280	4061
F45P2016I	-20	1.1/4"	31.8		1"	47.6	36	100	210	3046
F45P2020I	-20	1.1/4"	31.8		1.1/4"	54	43	104	210	3046
F45P2024I	-20	1.1/4"	31.8		1.1/2"	63.5	44	107	210	3046
F45P2424I	-24	1.1/2"	38.1		1.1/2"	63.5	41	118	185	2683
F45P2432I	-24	1.1/2"	38.1		2"	79.4	52	119	185	2683
F45P3232I	-32	2"	50.8		2"	79.4	59	153	172	2495