

## BANJO BSPP – MALE BSPP

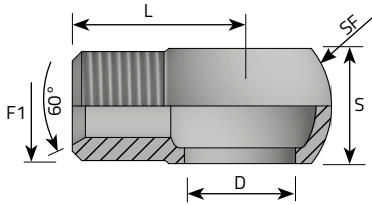

OCCHIO GAS CILINDRICO - MASCHIO GAS CILINDRICO SV 60°  
**BANJO BSPP – MÂLE BSPP**  
 RINGNIPPEL ZÖLLIG / AG- ZÖLLIG  
 ESFERICO BSPP – MACHO BSPP

**F1** Zylinder-Gasgewinde, Gas cilindrico, BSPP, Gaz cylindrique,  
 Gas cilíndrica

Code	Thread	Dimensions				Pressure	
		D	S	L	SF	Bar	Psi
F1		mm	mm	mm	mm		
AOFG0202	1/8"	1/8"	10	24	17		
<b>AOFG0404</b>	<b>1/4"</b>	<b>1/4"</b>	<b>14</b>	<b>24</b>	<b>24</b>		
AOFG0604	1/4"	3/8"	17	29	28		
<b>AOFG0606</b>	<b>3/8"</b>	<b>3/8"</b>	<b>17</b>	<b>29</b>	<b>28</b>		
AOFG0608	1/2"	3/8"	22	35	32		
<b>AOFG0804</b>	<b>1/4"</b>	<b>1/2"</b>	<b>22</b>	<b>29</b>	<b>35</b>		
AOFG0806	3/8"	1/2"	22	32	35		
<b>AOFG0808</b>	<b>1/2"</b>	<b>1/2"</b>	<b>22</b>	<b>32</b>	<b>35</b>		
AOFG1208	1/2"	3/4"	30	41	46		
<b>AOFG1212</b>	<b>3/4"</b>	<b>3/4"</b>	<b>30</b>	<b>38</b>	<b>46</b>		
AOFG1612	3/4"	1"	38	42	58		
<b>AOFG1616</b>	<b>1"</b>	<b>1"</b>	<b>38</b>	<b>44</b>	<b>58</b>		